

**TYPAR®**

This is not a house.



# This is an opportunity.

With every new construction project, you're faced with challenges. How will the building stand up to moisture and air intrusion? How can you ensure optimal indoor air quality for future occupants? How can energy-efficiency be built in? How can you prevent erosion and protect the integrity of landscape design?

These sound like questions. But in reality, they're opportunities. And you can make the most of them with the **TYPAR® Weather Protection System** and the full line of TYPAR® construction products. No matter the type of building, or the cladding surrounding it, TYPAR provides a comfortable, sustainable environment.

Let's take a look inside.



# The TYPAR® Weather Protection System— The heart of the building envelope.

While a building's external appearance gets most of the spotlight, the story really starts beneath the surface, inside the building envelope. With the right products and proper installation, the building envelope not only helps control air and moisture intrusion, it's the cornerstone of a well-balanced, energy-efficient indoor environment.

The TYPAR Weather Protection System not only withstands the rigors of the construction site, it keeps delivering high performance long after the cladding is up. TYPAR® HouseWrap, TYPAR® Flashings, and TYPAR® Construction Tape work in harmony to ensure the comfort of the people who live, work, eat, and sleep within a building's walls.



**TYPAR® HOUSEWRAP**  
Controls moisture and promotes excellent indoor air quality.

**TYPAR® CONSTRUCTION TAPE**  
Provides a powerful seal at critical seams and joints.



**TYPAR® FLASHING**  
Guards against water intrusion  
at rough openings and framings.

**SEALANT TAPE**  
Seals and bonds at  
edges.



The elements never sleep. And neither do I.



Protecting this home is a full-time job. From fending off air and moisture to maintaining good indoor air quality, I can't afford to let down my guard. But thanks to my nonwoven nature, I'm ready to block water and air from entering the wall cavity, which helps keep the inside of these walls dry and healthy. Day and night.







# TYPAR® HouseWrap.

Your first (and last) line of defense.

On the construction site, TYPAR HouseWrap defends against the elements better than any other housewrap. In fact, properly installed, our tear strength is five times better than the competition, which means it can weather the strongest of storms and wickedest of winds.

After the cladding is up, TYPAR HouseWrap keeps on working, defending against air and moisture—inside and out. As a weather barrier, it keeps cool air out during cold months and retains it during warmer weather, creating a comfortable, energy-efficient environment.

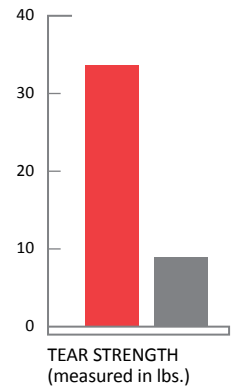
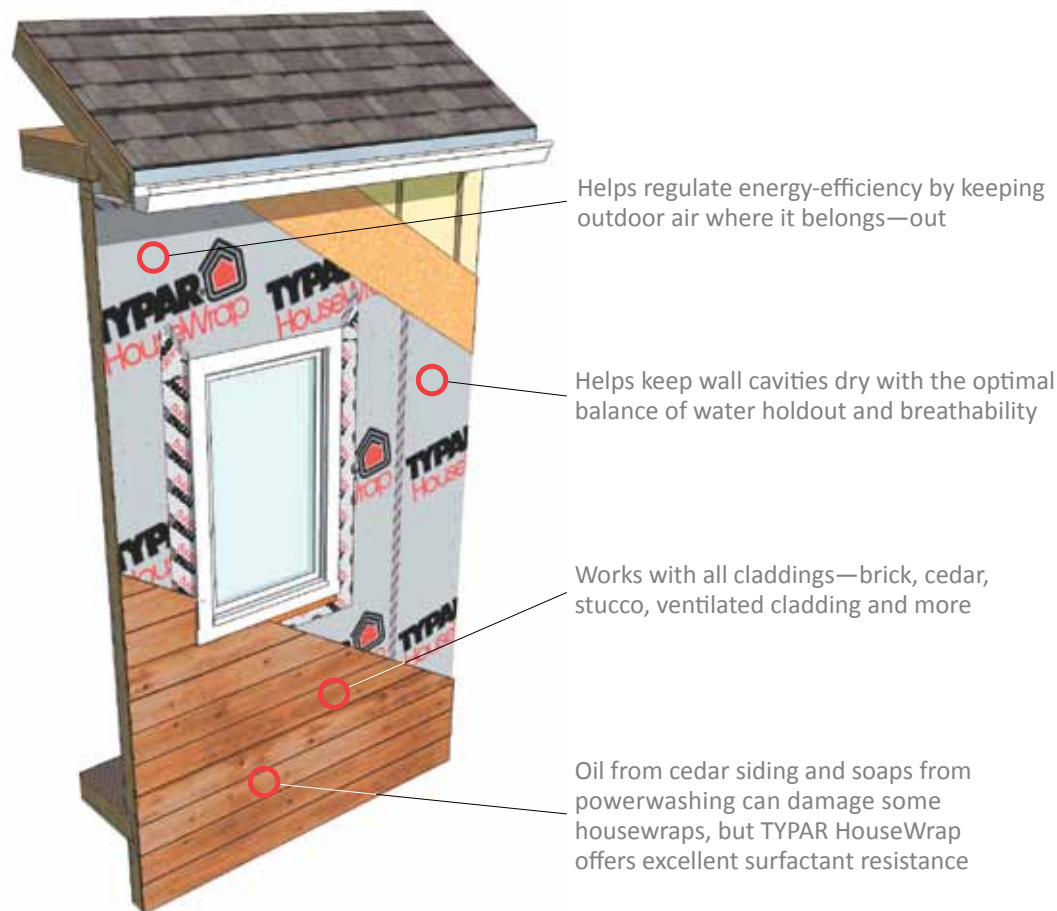

Based on published results for tear strength according to ASTM D5733-99 testing.

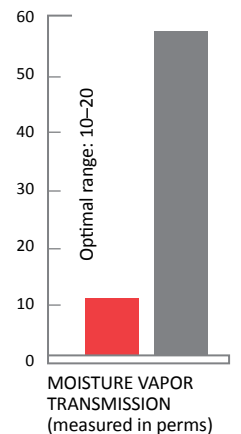

Based on published results according to ASTM E96-05 Procedure A testing. \*Source: Fiberweb, Inc.

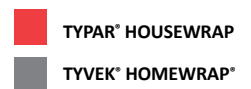



**TYPAR**   
Weather Protection System

# The TYPAR® Weather Protection System.

It's more than a system. It's a team effort.

Of course, TYPAR® HouseWrap performs exceptionally well on its own, but when teamed up with TYPAR® Flashings and Construction Tape, it's virtually unstoppable. For sealing areas around windows, doors, corners, and joints, you won't find a more reliable crew anywhere.

- **TYPAR® Flashing Flex.** This composite, conformable peel-and-stick flashing seals areas around curved windows, window flanges, sill plates, corners, and joints.
- **TYPAR® Flashing BA.** A non-staining butyl adhesive (BA) flashing ideal for a range of applications. Best of all, it bonds tight, even on the hottest days.
- **TYPAR® Flashing RA.** A versatile, self-adhering flashing with rubberized asphalt (RA) provides great performance at a great price.
- **TYPAR® Construction Tape.** Strong, coated polypropylene tape firmly seals seams and edges. Use on window flanges, corners, joints, and seams, or to repair rips and punctures.

## We stand behind our products. And their performance.

Chances are, you're not going to need to take advantage of our industry leading warranty. But when you use the full TYPAR Weather Protection System—TYPAR HouseWrap, Flashings, and Construction Tape—you're covered by a lifetime limited product warranty plus an incredible 10-year Start Smart warranty on materials and labor. If a problem is going to occur, it's most likely going to happen a few years after construction is complete. The Start Smart warranty keeps you covered so you don't incur any additional material or installation costs down the road.

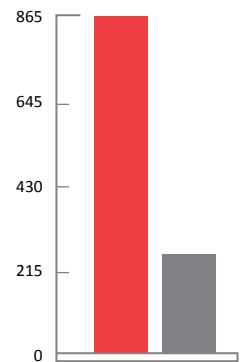

WATER HOLDOUT  
(measured in cm.)

Based on published results according to AATCC-127 testing. Based on published results according to ASTM D5733 testing.

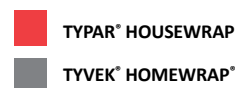

For me, going to extremes is second nature.



Weathering the storm means not only keeping the elements out, but also preventing moisture vapor that tries to infiltrate the wall cavity. It's my job to keep things dry, which helps keep mold from rearing its ugly head. Yeah, I'm pretty tough. So bring it on.





# Home Slicker® Plus TYPAR®

Drastic conditions call for dramatic protection.

TYPAR® HouseWrap has teamed up with Home Slicker® to provide enhanced bulk water resistance, specifically designed for wet and coastal climates. Two great products rolled into one unbelievably tough barrier. So when it rains, Home Slicker® with TYPAR HouseWrap really pours on the protection.

- **Defends against extreme elements.** Allows moisture to escape quickly as vertical channels direct water out of the wall assembly.
- **Saves time and money.** Installing two moisture-management products at one time saves time and money, and eliminates the need for furring strips.
- **Provides cladding flexibility.** Ideal for use with wood, fiber cement, vinyl siding, and more.

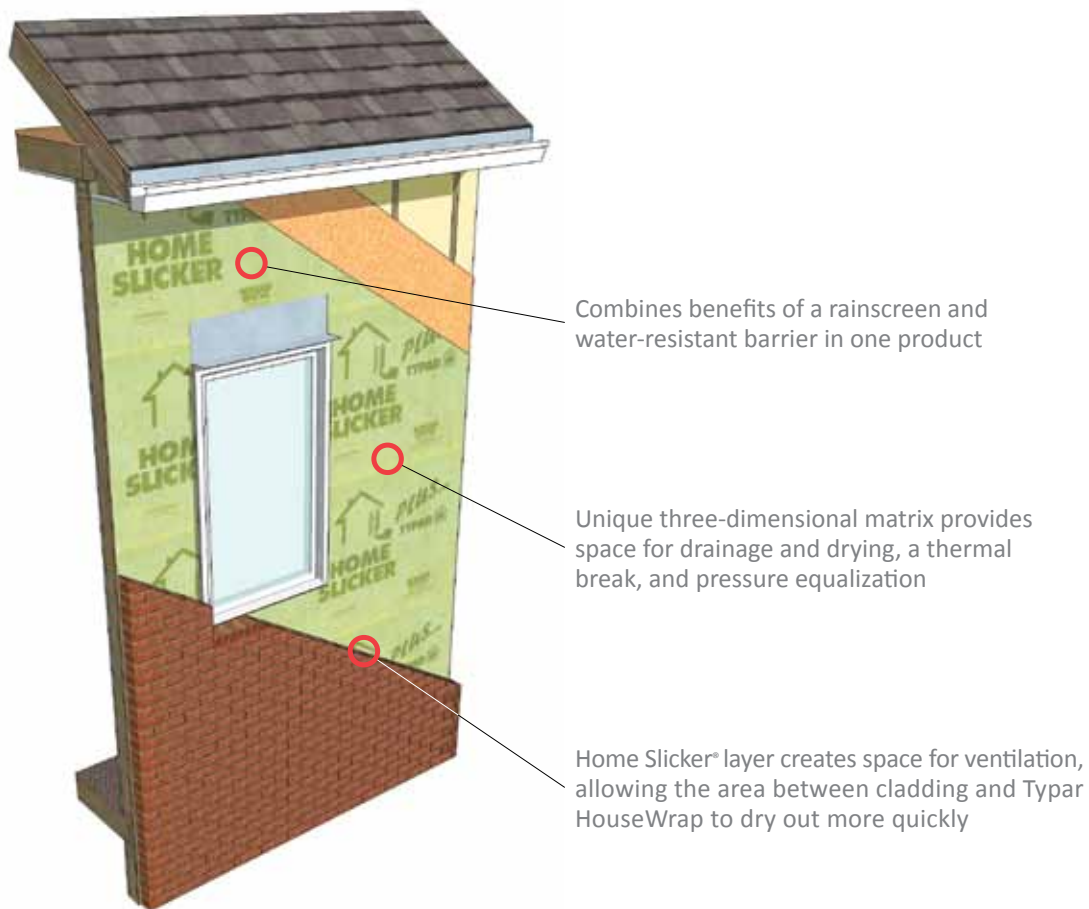

I'm somewhat of a workaholic.





In my position, time off isn't an option. Mother Nature attacking from the outside. Moisture vapor trying to permeate the wall cavity from the inside. Protecting this home—and the people inside its walls—is a balancing act, a round-the-clock job. It's tough, but somebody's got to do it.





# TYPAR® MetroWrap™

## Taking performance to a higher level.

While TYPAR® HouseWrap has the residential market covered, TYPAR MetroWrap brings the same level of toughness and protection to commercial buildings and multi-family dwellings. It's engineered to withstand the pressure and elements above four stories.

- **Holds strong during construction.** Up to five times stronger than the leading polymeric wraps, and up to 20 times stronger than building paper.
- **Increases energy-efficiency.** Helps prevent wind and water infiltration, which increases the efficiency of HVAC systems and creates a comfortable, well-balanced indoor environment.
- **Helps prevent mold.** Will not support the growth of mold (ASTM D3273).
- **Resists surfactants.** Handles exposure to harsh chemicals and cleaning techniques found on commercial jobsites.
- **Protects against UV damage.** Protects up to 12 months from UV degradation; perfect for evolving construction schedules.

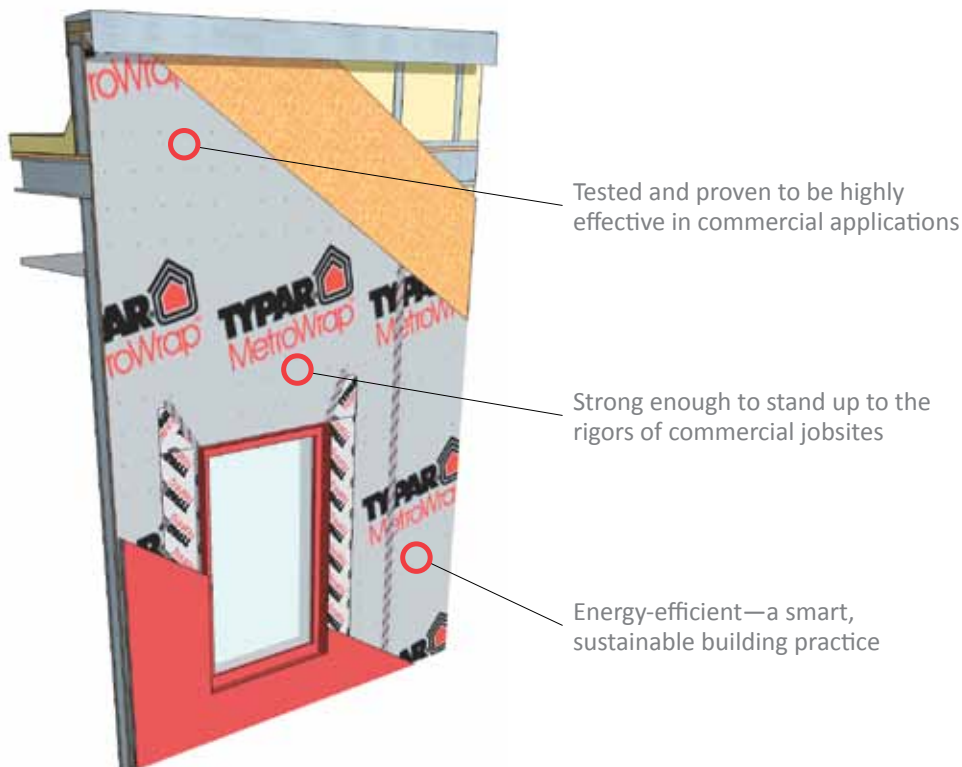



**Surround**  
SR Underlayment  
A Tytar® Brand

# Surround® SR Roof Underlayment.

It's lonely at the top. But it's well protected.

Pelting rain. Shearing crosswinds. Blazing heat. Surround SR Roof Underlayment can take it. It's made of a tough synthetic polymer that protects against the harshest of elements. Plus, it's strong, light, and easy to install. If you're looking for top performance and protection, Surround SR Underlayment delivers.

- **Quick, easy installation.** Covers more area with fewer rolls than traditional felt, which saves time and labor costs.
- **Strong choice.** When properly installed, Surround SR Underlayment won't tear or blow off. It meets the requirements of ICC AC48—Acceptance Criteria for Roof Underlayment in Severe Climate Areas.
- **Provides a slip-resistant surface.** Surround SR Underlayment keeps you safer on the deck because it remains slip-resistant even when wet.
- **Backed by a 30-year warranty.** Rest easy knowing your roof is protected against moisture intrusion for 30 years with our limited product replacement warranty.

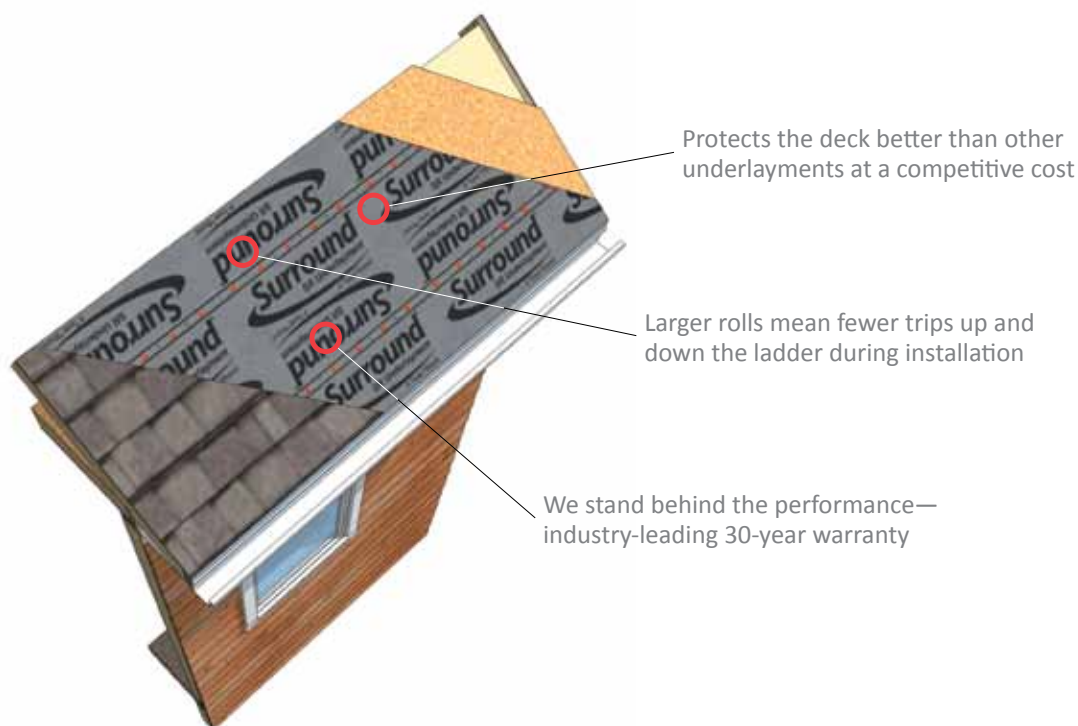



# Multiple claddings. One answer.

When it comes to protecting the building envelope, the TYPAR® Weather Protection System has always been a smart choice. But today, TYPAR® materials are more relevant (and more important) than ever. They're engineered to last—not just within individual buildings, but as a viable solution in an ever-changing construction market.

Building professionals are looking for new and better ways to ensure the highest performance of a building, both during construction and for many years to come. And that's exactly what the TYPAR Weather Protection System delivers.

**The TYPAR Weather Protection System—  
an excellent choice to use with these claddings:**

- Brick
- Vinyl siding
- Wood panels
- Cedar shakes
- Fiber cement siding
- Stucco/EIFS
- Ventilated cladding systems
- Aluminum, steel and composite panels



# TYPAR® Geotextiles.

If you're looking for stability, protection, and separation for a variety of applications—roads, industrial yards, surface drains, recreational facilities, septic systems, and more—look no further than TYPAR Geotextiles. Made of a highly durable, nonwoven polypropylene fabric, they're easy to install, which saves time and money.

For more than 35 years, builders, contractors, civil engineers, and building owners have put their trust in TYPAR Geotextiles.

# TYPAR® Geocells.

The TYPAR Geocells system retains project fill material and soil particles while allowing water to filter through. Simply expand one of the lightweight units, fill it with ballast material, and you're on the way to controlling stormwater at your construction site. For the sediment and erosion solution that is cost-efficient and project-effective, try the TYPAR Geocells system today.

- Made of time-proven TYPAR® geotextile fabric
- Honeycomb-style for custom sizes, configuration
- Easy to construct
- Well-suited for irregular terrain
- Stable, strong and durable
- Multiple applications:
  - Erosion control
  - Rapid flood control
  - Levees
  - Sediment ponds
  - Stormwater containment and filtering





## TYPAR® Geotextiles.



TYPAR Geotextiles are the trusted product of choice in residential and commercial neighborhoods. Engineered for durability, these high-quality fabrics provide high tensile strengths at a lower basis weight than competitive products. The result? Reliable, long-lasting performance. For effective separation, reinforcement, and stability of soils at your jobsite, use TYPAR Geotextiles.

- Multiple applications:
  - Paved roads
  - Parking lots
  - Septic systems
  - Subsurface drains
  - Recreation areas
  - Landscaped areas, including ponds, retaining walls, and gravel or stone paths

## TYPAR® BioBarrier.®

The beauty of a building is naturally enhanced by the design of the landscaping around it. TYPAR BioBarrier Protection Fabric protects your landscapes and hardscapes from damage caused by costly root intrusion. It keeps sidewalks, patios, parking lots, and landscaped areas safe from root growth, without harming trees, shrubs, or other plants.

- **Cost-effective.** Costs less than many plastic diverters; easy installation means less labor costs; requires less grounds maintenance.
- **Plant- and tree-friendly.** Non-systemic herbicide redirects growth of root tips.
- **15-year warranty.** Reduces costly damage and callbacks.
- **Proven performance.** More effective long-term than landscape fabric.
- **Multiple applications:**
  - Green roofs
  - Retaining walls
  - Swimming pools
  - Foundations
  - Liquid-carrying pipes





# Don't just build beauty. Sustain it.

Long before sustainability was a buzzword, the TYPAR® brand was quietly contributing to greener buildings, because it helps conserve energy that results in savings on utility bills. Today, this tradition comes through in all of our products. Ultimately, TYPAR products support a more beautiful and sustainable world.

## TYPAR® Weather Protection System:

- **Contributes to energy-efficiency.** Seals buildings tightly, helping them conserve energy.
- **Supports green building practices.** TYPAR® HouseWrap and Flashings have been named Green Approved Products according to the National Green Building Standard.™
- **Made from recycled content.** TYPAR weather-resistant barriers contain 23 percent post-industrial recycled content.\*
- **Preserves healthier indoor air.** Reduces the risk of mold and the levels of dust, pollens, pests, and pollutants.
- **LEED® certification.** Use of the TYPAR Weather Protection System can contribute points toward LEED® certification.



## TYPAR® BioBarrier® Protection Fabric:

- **Protects hardscapes and landscapes.** TYPAR BioBarrier Protection Fabric helps prevent roots from damaging sidewalks and other landscape designs—without hurting trees and shrubs.

## TYPAR® Geocells:

- **EPA-compliant.** TYPAR Geocells help contractors and builders meet stringent EPA stormwater runoff rules, keeping sediment out of the water supply.

\*Actual amount may vary.



# Look beyond the surface.

At the end of the day, you want hardworking products that will stand the test of time and provide the highest level of performance. Whether inside a wall, under the shingles, or beneath the surface of the soil, TYPAR® brand products deliver on the construction site and well into the future.

To see how much more TYPAR products have to offer you and your buildings or facilities, both inside and out, visit [typar.com](http://typar.com).



Building Wraps Flashings Construction Tape

**TYPAR**®

Roof Underlayment Landscape Products Geotextiles

Fiberweb™  

Fiberweb, Inc. | 1-800-284-2780 | [www.typar.com](http://www.typar.com)

Made in the U.S.A. © 2010 Fiberweb, Inc. TYPAR®, Surround® SR Roof Underlayment, and TYPAR® BioBarrier® are registered trademarks of Fiberweb, Inc. TYPAR® MetroWrap™ is a trademark of Fiberweb, Inc. Home Slicker® is a registered trademark of Benjamin Obdyke. TYVEK® HomeWrap® is a registered trademark of E.I. DuPont. Lit# TYPFL 11001