



INSTALLATION INSTRUCTIONS

Factory-Finished Exterior Engineered Wood Siding Products

The following steps should be followed to ensure years of optimal performance

DISCLAIMER

Although these instructions for the installation of exterior siding products were designed with as much precision as possible, and in accordance with current practices, Goodfellow is not liable for any errors or omissions that may result from the use of this guide. All installers and property owners assume all risks and responsibilities.

These instructions represent optimal installation practices but do not replace or substitute applicable building codes and standards. As such, it is the installer's duty and responsibility to take all available documentation into account prior to completing work to ensure the validity of the product warranties.

Finally, the technical drawings provided in this document serve as a guide and do not represent all construction requirements of codes and standards.

Lap Siding

GENERAL

- Install the siding in a manner that prevents moisture penetration and water accumulation.
- All exposed engineered wood substrate must be primed and painted to prevent moisture penetration and water accumulation.
- Install siding with continuous ventilation as specified herein.
- Follow the national building codes and annexes to ensure a compliant installation.

STUD SPACING

When applying siding directly to structural studs or walls without structural sheathing, ensure studs are spaced no more than maximum distance indicated on the product.

MOISTURE AND CONDENSATION

- Moisture control is a critical element of proper construction. Consult applicable building codes and annexes for requirements regarding installation of vapour barriers and waterproof coatings.
- As with all wood products, never apply machined and treated wood materials to structures with excessive moisture conditions, such as curing concrete or plaster, until they are dry. If necessary, ventilate the building to accelerate drying before installing GOODSTYLE 2.0 products.
- Ensure proper ventilation of the back side by having a continuous cavity between the siding and the vapour barrier. This cavity must be properly ventilated to eliminate water, moisture and any heat that may accumulate. As ventilation relies on natural convection from bottom to top, it is essential to incorporate openings at both the bottom and top of the wall for effective airflow. Ensure nothing blocks air from flowing freely through this cavity.
- It is recommended that this cavity be protected with ventilated (perforated) anti-rodent or mosquito screens.
- It is strongly recommended to install gutters to control roof water runoff and reduce the harmful effects of excessive moisture near the walls.
- Failure to follow ventilation instructions will result in premature deterioration of siding and finish. Rapid discolouration, peeling paint, as well as swelling and/or cracking of edges are direct results of inadequate ventilation.
- Do not install GOODSTYLE 2.0 products on twisted or green wood framing.
- All exposed engineered wood substrate must be primed and painted to prevent moisture penetration and water accumulation.

VAPOUR/WATERPROOFING BARRIERS

- Consult applicable building codes and annexes and apply appropriate vapour and waterproofing barriers.
- Goodfellow is not responsible for water infiltration into the wall.

GAPS AND SEALANTS

All areas of the building where water could infiltrate must be sealed with a high-quality, paintable sealant with a stated service life of 30 years. Follow sealant manufacturer's instructions for application.

LOWER WALL OPENING



Foundation equal with the wall

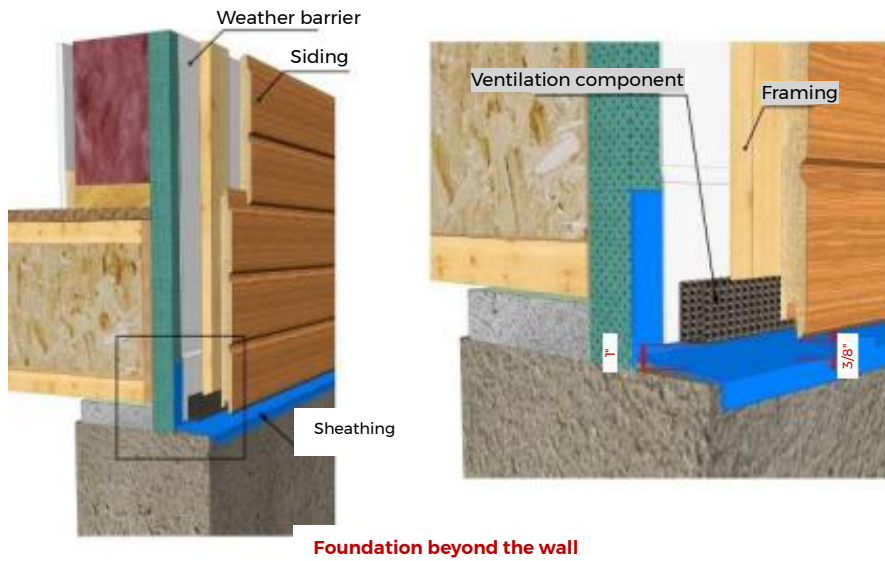

Foundation behind the wall

UPPER WALL OPENING

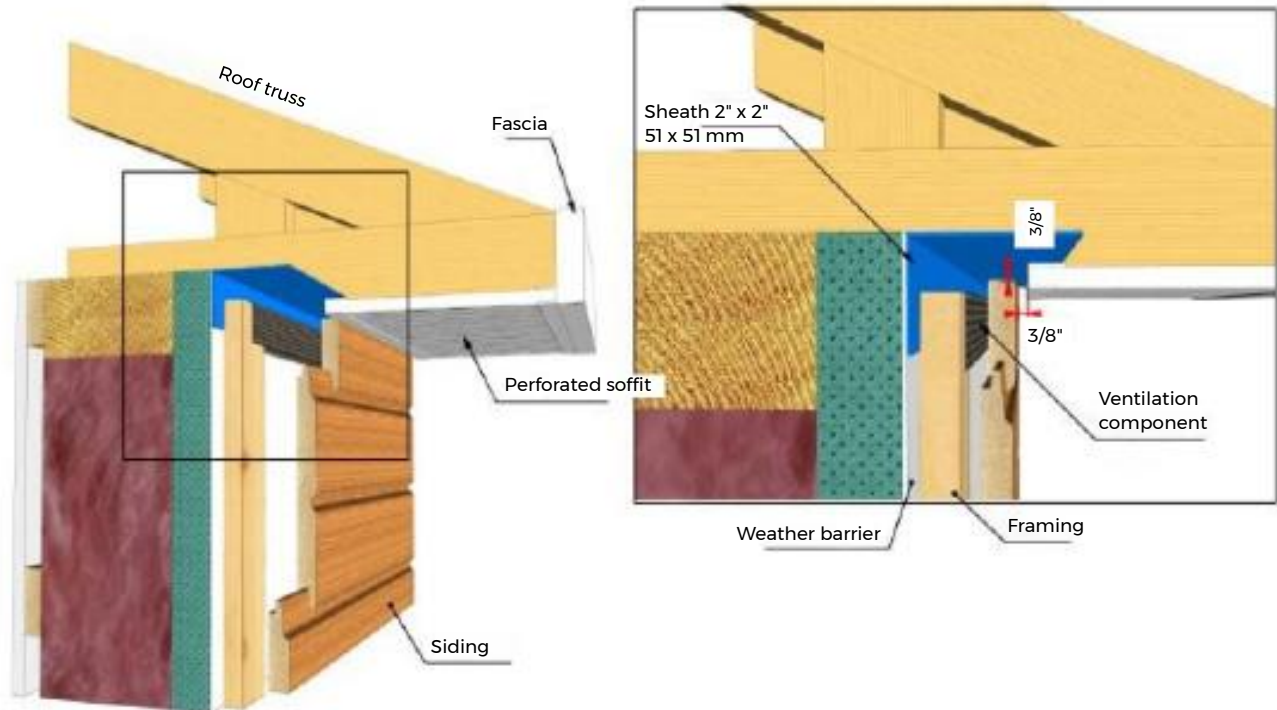

FLASHING, DOORS, WINDOWS AND OPENINGS

- Installation of gutters and flashing is recommended.
- All openings must be properly sealed, and windows and doors must be flashed in a manner that prevents moisture from penetrating or water from accumulating in the siding. Several "how-to" examples are provided on the following pages.
- Siding installed next to porches, decks, walkways, etc., must have a minimum clearance of 2" (51 mm) above any surface where water may collect, and must be sloped or built to drain properly thereby ensuring the siding is never directly exposed to standing water.

TRIM AND FASCIA

- GOODSTYLE 2.0 lap siding is not designed or manufactured for use as roof trim or fascia.
- Trim and fascia must be installed to prevent moisture penetration or water accumulation.
- Trim should be large enough so that the siding does not extend beyond the face of the trim.
- Install ventilation and starter strips to ensure sufficient ventilation and proper alignment of the siding.

FINISHING

- Apply two 2 coats of paint to all cuts made during installation to prevent moisture from penetrating into the siding, trim and fascia.
- Use touch-up paint provided by Goodfellow. No other touch-up paints should be used during original installation.

ATTENTION:

- Touch-up paint should only be used on field cuts made during installation. Under no circumstances should it be applied to factory stained materials that have not been exposed. If touch-up paint is applied to factory-stained materials, the colour difference will appear over time due to prolonged exposure to ultraviolet rays the sun.
- Goodfellow is not responsible for colour variations following touch-up paint application, nor for variations in gloss or chalking.

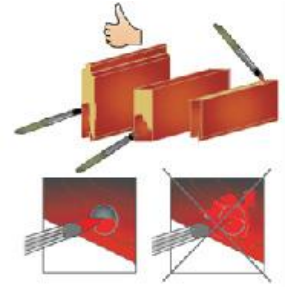

NAILING

- Use corrosion-resistant, flat-head nails with a minimum length of 8d.
- Drive nails at least 1-1/2" into the studs and wood sheathing.
- Nail the siding to each of the studs with maximum spacing of 16" OC.
- If siding is to be installed over structural insulated panels (SIPs), follow the manufacturer's nailing instructions.
- **Do not use staples.**

CAUTION:

- Whenever possible, avoid face nailing. When it is not possible to avoid it, such as near doors, windows or other openings, seal all exposed nails to prevent moisture penetration and water accumulation.
- Do not force the panels when installing them.
- **The use of staples will void the warranty.**

OVERLAPPING, SPACING AND NAILING

- Nail at 1/2" to 3/4" from the top and 3/8" from the ends.
- Allow at least 3/16" between butt joints.
- Seal all gaps between butt joints or use aluminum flashing that matches the siding colour.
- All siding joints must fall on studs.
- Follow sealant manufacturer's instructions for application.

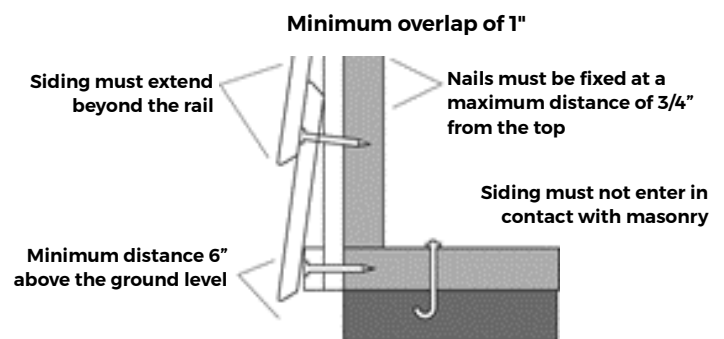
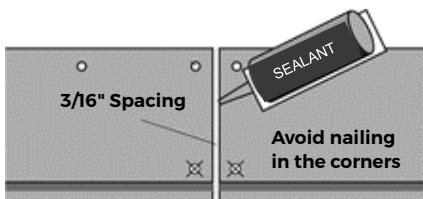

Trim and Fascia

GENERAL

- Install the trim and fascia in a manner that prevents moisture penetration and water accumulation.
- GOODSTYLE 2.0 trim and fascia are not designed for structural applications; they should not be used as structural elements in construction.
- Trim and fascia can be installed directly over materials such as siding, or nailed directly to structural members spaced up to 24" OC.
- Trim must not be in contact with masonry.
- Minimum 6" clearance must be maintained between trim and finish grade.
- Trim applied next to porches, patios, walkways, etc., must have a clearance of at least 3/8" above any surface where water may collect.
- A non-corrosive drip-edge or drop-cap must be installed at bottom edge of roofing where it meets the fascia.
- All exposed engineered wood substrate of trim and fascia (if applicable) must be primed and painted to prevent moisture penetration and water accumulation.

GABLE ENDS

At gable ends, a backer board should be used under the fascia to provide maximum support along the entire length of the product.

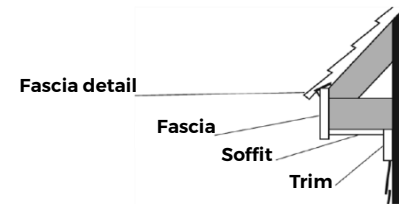

MOISTURE AND CONDENSATION

- Moisture control is a critical element of proper construction. Consult applicable building codes and annexes for requirements regarding installation of vapour barriers and waterproof coatings.
- As with all wood products, never apply machined and treated wood materials to structures with excessive moisture conditions, such as curing concrete or plaster, until they are dry. If necessary, ventilate the building to accelerate drying before installing GOODSTYLE 2.0 products.
- Ensure proper ventilation of the back side by having a continuous cavity between the siding and the vapour barrier. This cavity must be properly ventilated to eliminate water, moisture and any heat that may accumulate. As ventilation relies on natural convection from bottom to top, it is essential to incorporate openings at both the bottom and top of the wall for effective airflow. Ensure nothing blocks air from flowing freely through this cavity.
- It is recommended that this cavity be protected with ventilated (perforated) anti-rodent or mosquito screens.
- It is strongly recommended to install gutters to control roof water runoff and reduce the harmful effects of excessive moisture near the walls.
- Failure to follow ventilation instructions will result in premature deterioration of trim and fascia, and its finish. Rapid discolouration, peeling paint, as well as swelling and/or cracking of edges are direct results of inadequate ventilation.
- Do not install GOODSTYLE 2.0 products on twisted or green wood framing.

FLASHING, DOORS, WINDOWS AND OPENINGS

All openings must be properly sealed or flashed in a manner that prevents moisture penetration and water accumulation. To do this, use caulking or flashing. Several examples are illustrated below.

Minimum overlap of 2"

Minimum space of 3/16" behind the mouldings

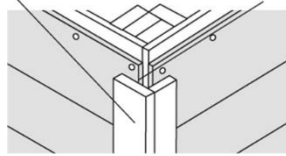

Detail - Outside angle

The trim must extend beyond the face of the siding

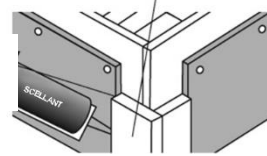

Detail - Outside angle
Other solution

The trim must extend beyond the face of the siding

3/16" space

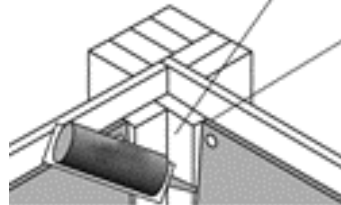

Detail - Inside angle

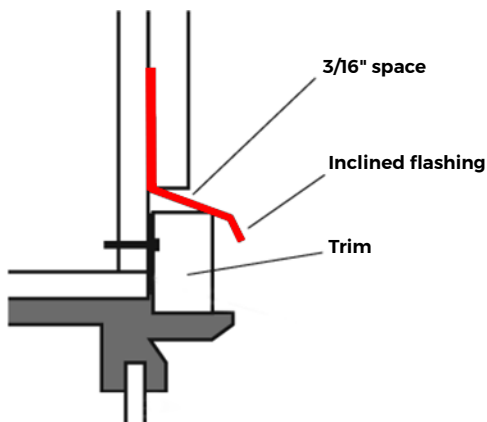
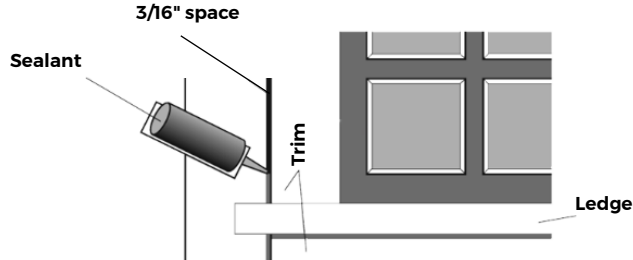

Doors and windows

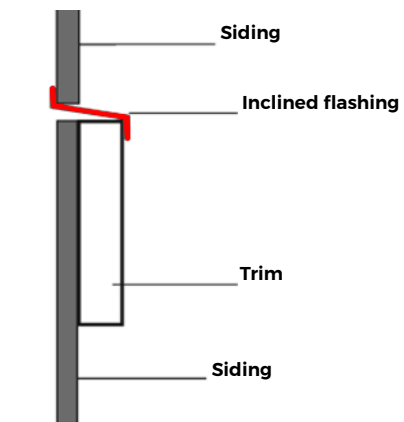

Horizontal trim

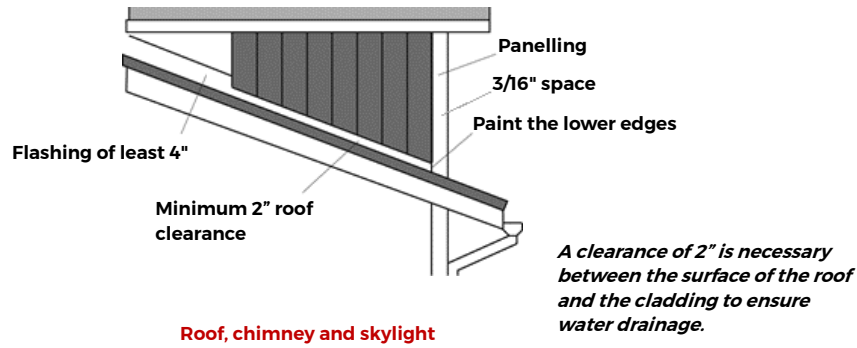

GAPS AND SEALANTS

Seal all gaps with a high quality, paintable sealant with a stated service life of 30 years. Follow sealant manufacturer's instructions for application and backer rod requirements.

CUTTING

- Use a fine-tooth saw blade to achieve the cleanest cuts.
- GOODSTYLE 2.0 trim and fascia have a special edge coating that reduces moisture-related issues. Ripping trim and fascia is not recommended, as it will leave the edges unprotected. However, if edges must be ripped apply two coats of touch-up paint and seal all exposed wood fibers, as described in the finishing section.

FINISHING

- Apply two coats of paint to all cuts made during installation to prevent moisture from penetrating into the siding, trim and fascia.
- Use touch-up paint provided by Goodfellow. No other touch-up paints should be used during original installation.

ATTENTION:

- Touch-up paint should only be used on field cuts made during installation. Under no circumstances should it be applied to factory stained materials that have not been exposed. If touch-up paint is applied to factory-stained materials, the colour difference will appear over time due to prolonged exposure to ultraviolet rays the sun.
- Goodfellow is not responsible for colour variations following touch-up paint application, nor for variations in gloss or chalking.

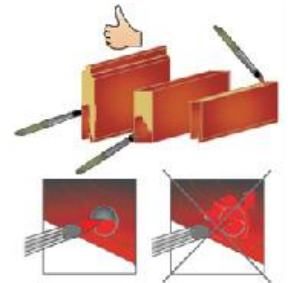

NAILING

- Use corrosion-resistant nails (ASTM 641 -compliant), minimum 8d in length, with a minimum 1/4" diameter head.
- Nail at all studs, with maximum spacing of 16" OC.
- Leave 3/16" gap where trim butts into other materials, as well as at butt joints, miter joints and ends.
- Leave 2" gap between trim and roofing materials, at the slope of the roof.
- **Do not use staples.**

CAUTION: *The use of staples will void the warranty.*

STATE

Adjusted

Lost head

Apparent fiber

Buried 1/16" - 1/8" (1.6 - 3.2 mm)

Buried more than 1/8" (3.2 mm)

CORRECTION

Correct

Correct

Paint

Seal with caulking

Seal with caulking and nail again



ANY DEVIATION FROM THE MANUFACTURER'S INSTRUCTIONS WILL VOID THE WARRANTY

The product warranty and other information is available online at:

goodfellowinc.com